

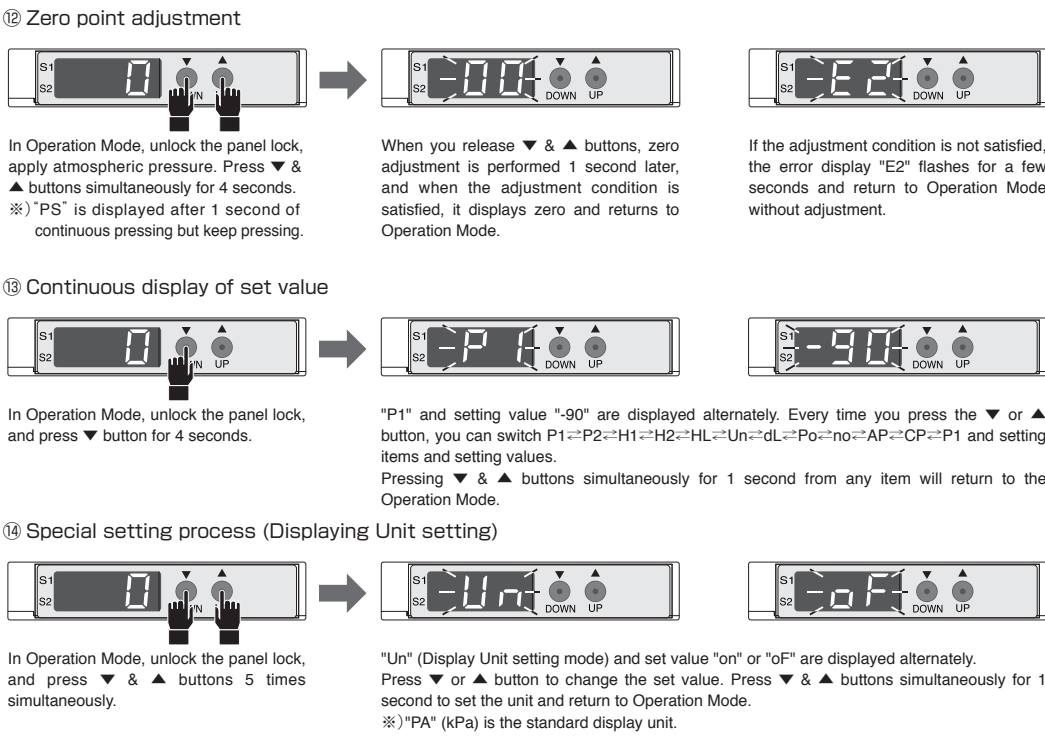

- ### ⚠ Safety Instructions
- Warnings
 - 1. This product must not be used in the gas or ambience where corrosive substance is dissolve.
 - 2. Avoid using this product in the inflammable and explosive gas, liquid or ambience. This product is not designed to be explosion-proof and may cause fire or explosion.
 - Cautions
 - 1. Make sure to use a stable DC power supply.
 - 2. This product shall not be used in the temperature higher than the specified range thus generating heat. To do so can cause damage to the sensor.
 - 3. Make sure that the power supply is turned off when wiring. Make sure of the colors of the lead wire and terminal numbers so that the output terminal and the power supply terminal or the common terminal shall not be shorted out. If this happens, it can cause damage to the sensor.
 - 4. Make sure to provide the surge voltage absorption circuit in the relay or valves that connect to the output or power supply terminals. Also, make sure to avoid instability that the power supply exceeds the rating.
 - 5. When using a unit power source such as a switching power supply, make sure to ground the FG terminal.
 - 6. The output terminal shall never be short circuited with other terminals.
 - 7. When handling the sensor, do not apply twist or pull to the connection part of Tube Fitting and sensor case. When wiring, do not allow tension load to the main body and make some allowance for cable length. Doing so may cause breaking of the connection part.
 - 8. If wiring or usability applying a noise or so, it may cause malfunction.
 - 9. Do not give a strong tensile force or extreme bending to the lead wire. It may cause breakage of the wire or the connector.
 - 10. Avoid pressing the setting buttons with a sharp pointed tool. It may break the buttons.
 - 11. Do not apply excessive force to the setting button. It leads to breakage of the button or the product itself.
 - 12. Avoid pressing the display excessively with a finger. The seal may drop out or be broken.
 - 13. When affixing the sensor via DIN railing, make sure that the width of the DIN rail to be used is 35mm wide.
 - 14. If there is still vibration or shock to the sensor after the DIN railing, add extra DIN railings (available in the market) on both sides of the sensor to further stabilize the sensor. The sensor can come off of the railing from the excessive vibration or shock.
 - 15. Be careful not to overload the release lever of the DIN railing. Excessive load may break the lever. When the tube is connected or disconnected on the condition that the sensor is affixed to the DIN railings particularly, hold the main body by hand not to overload the release lever.
 - 16. The LED display is covered with a protective film at shipment. Please remove it as necessary.
 - 17. The cartridge fitting can be attached and removed by pulling out the lock pins, but make sure the lock pins are surely installed on the operation.
 - 18. Do not use the sensor in locations exposing to water drops, oil drops, dust, etc. It is neither drip-proof nor dust-proof structure, so it may cause malfunction.

Specifications				
Spec	Energy saving / Vacuum	2-point SW output / Vacuum	Energy saving / Compound pressure	3-point SW output / Compound pressure
Model Code	VUS8A-□-EN VUS8A-□-EP	VUS8A-□-SN VUS8A-□-SP	VUS8A-□-ERN VUS8A-□-ERP	VUS8A-□-SRN VUS8A-□-SRP
General Specifications	Fluid medium			
	Pressure detection method			
	Operating temperature range			
	Storage temperature range			
	Operating humidity range			
Pressure	Vibration proof			
	Shock resistance			
	Protective structure			
	Operating pressure range			
	Pressure proof			
Power supply	Power supply			
	Current consumption			
	Display element			
	Display frequency			
	Monitor system			
Display	Panel lock function			
	On / Off by push-button			
	Non-display function			
	Indication accuracy			
	Temperature characteristics			
Switch output	Zero point adjustment			
	Number of output			
	Output method			
	Switch capacity			
	Residual voltage			
Output mode	SW1			
	SW2			
	Pressure setting range			
	Operational indication			
	Temperature characteristics			
Response time	Hysteresis adjustment			
	Overload protection			

Thank you for purchasing PISCO product. Please be sure to read this User's Manual before using this item in order to make sure the safety. Please keep this manual handy with care, so that you can refer to it whenever necessary.

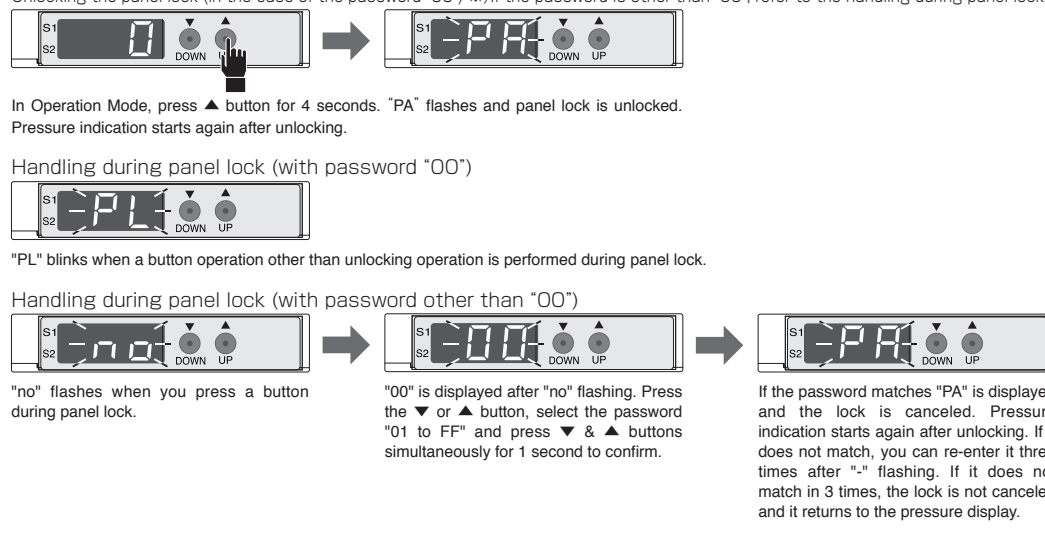
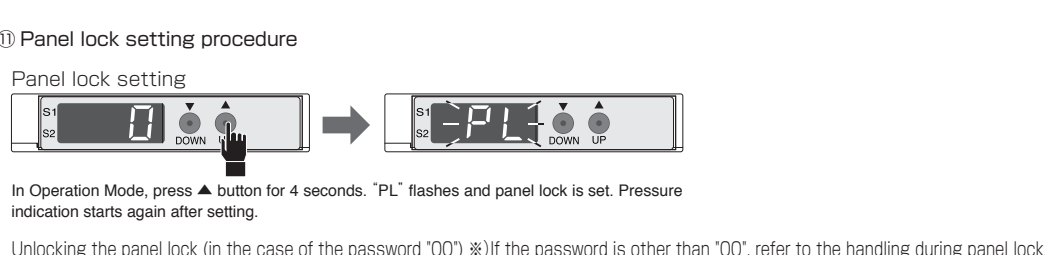
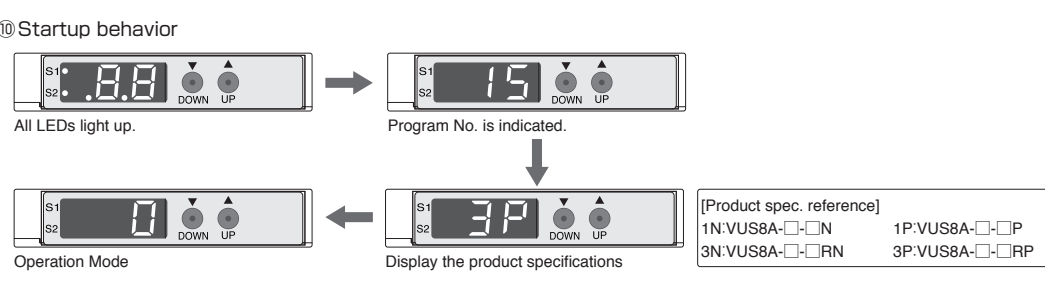
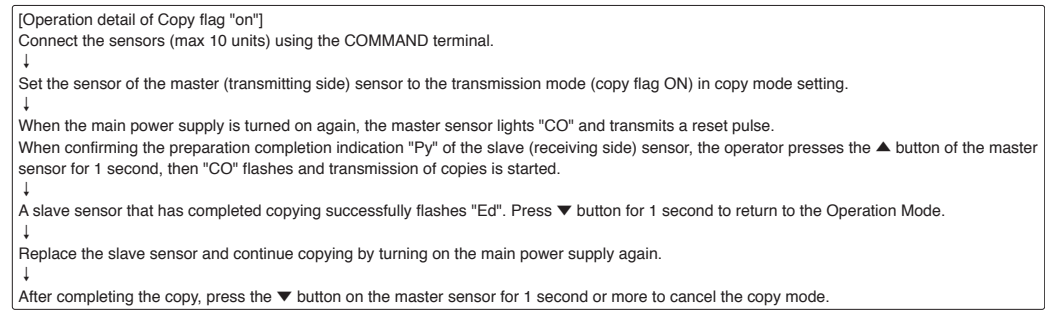
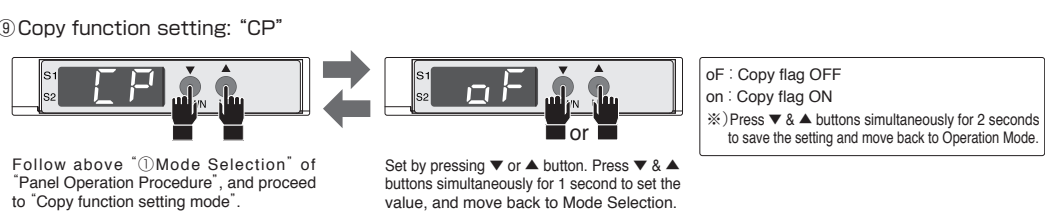
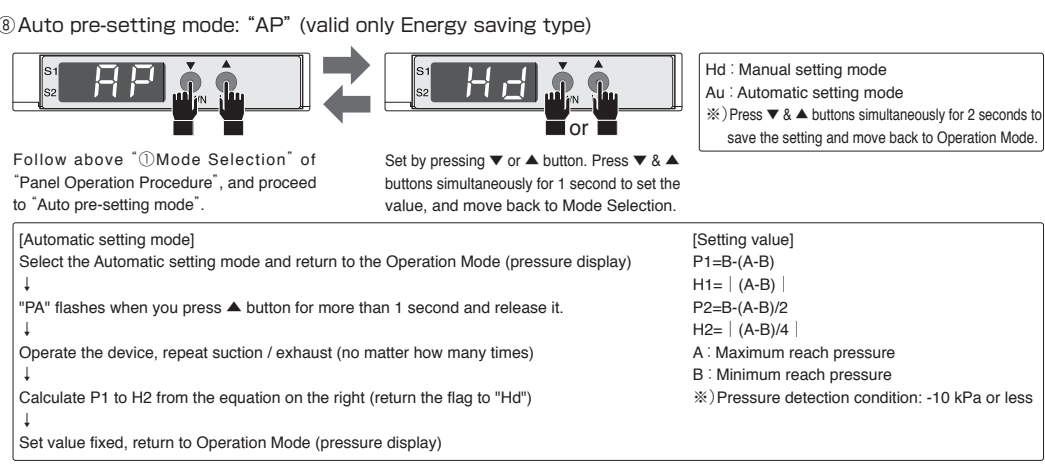
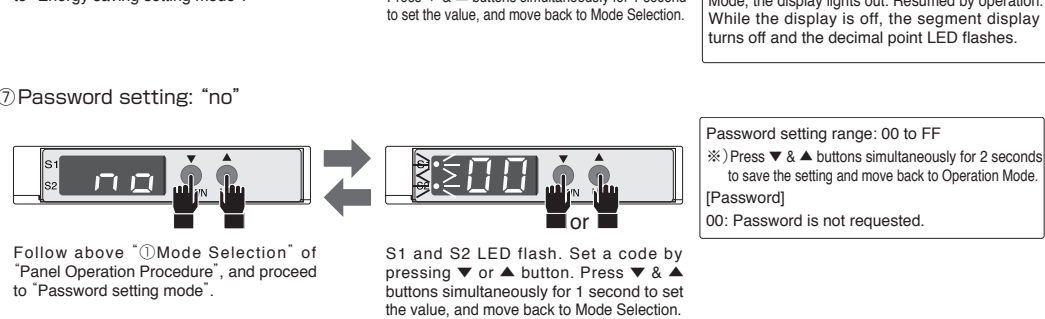
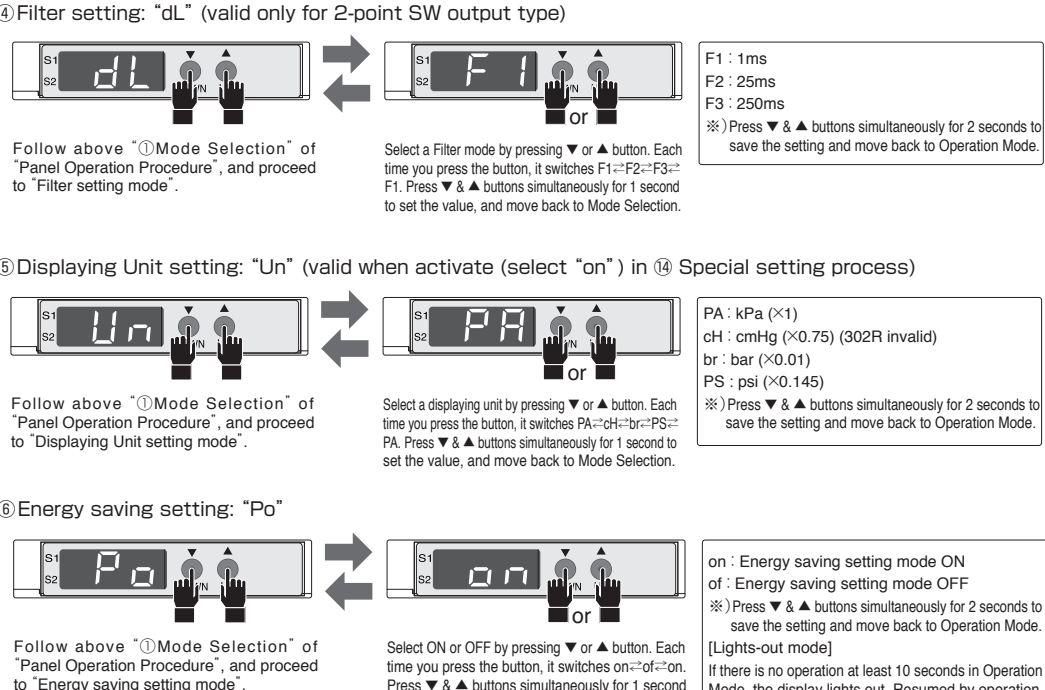
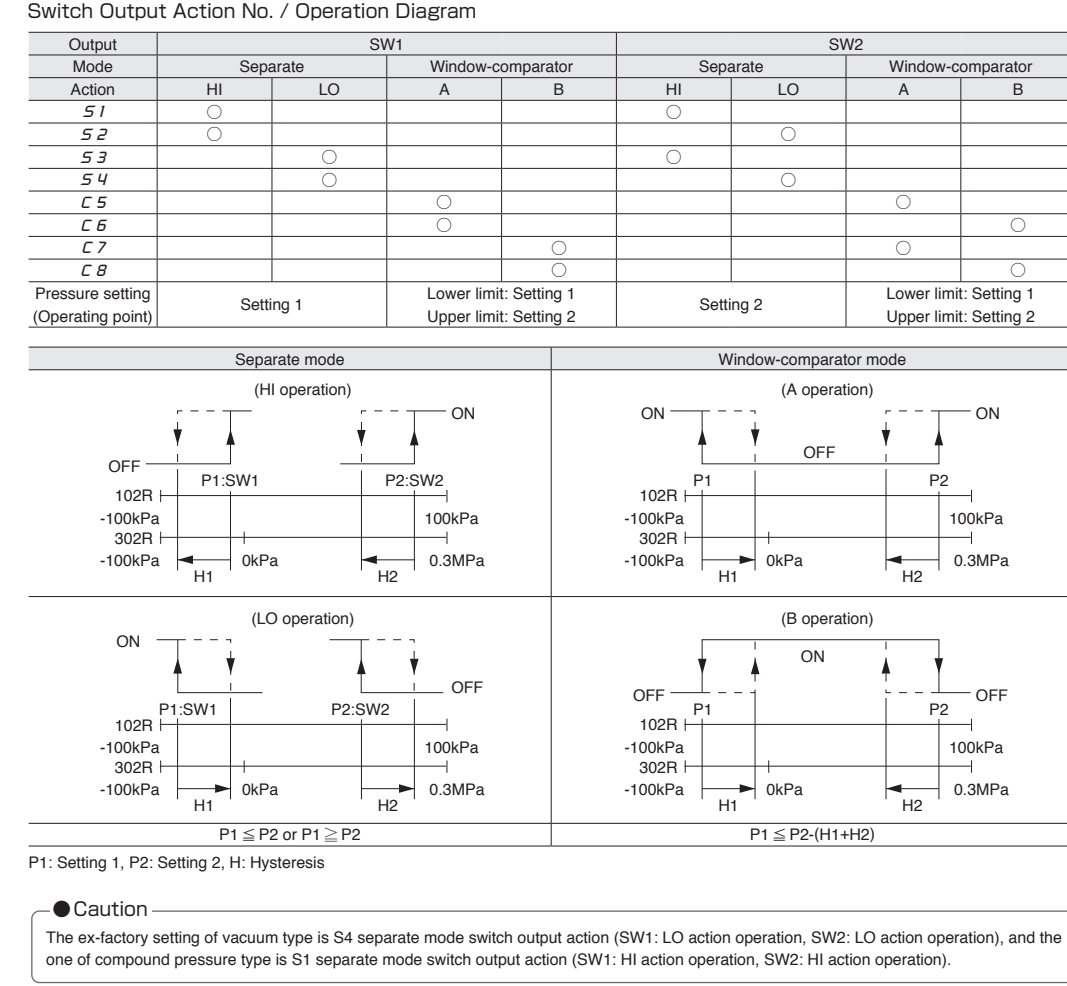
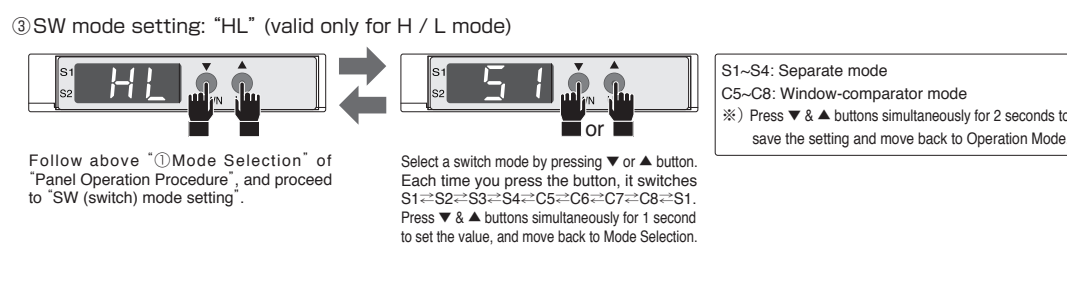
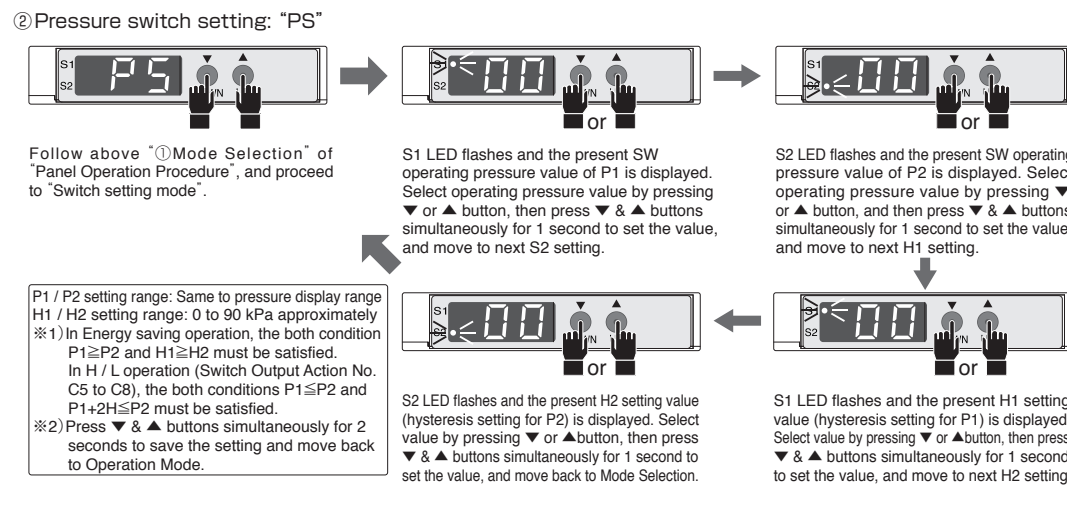
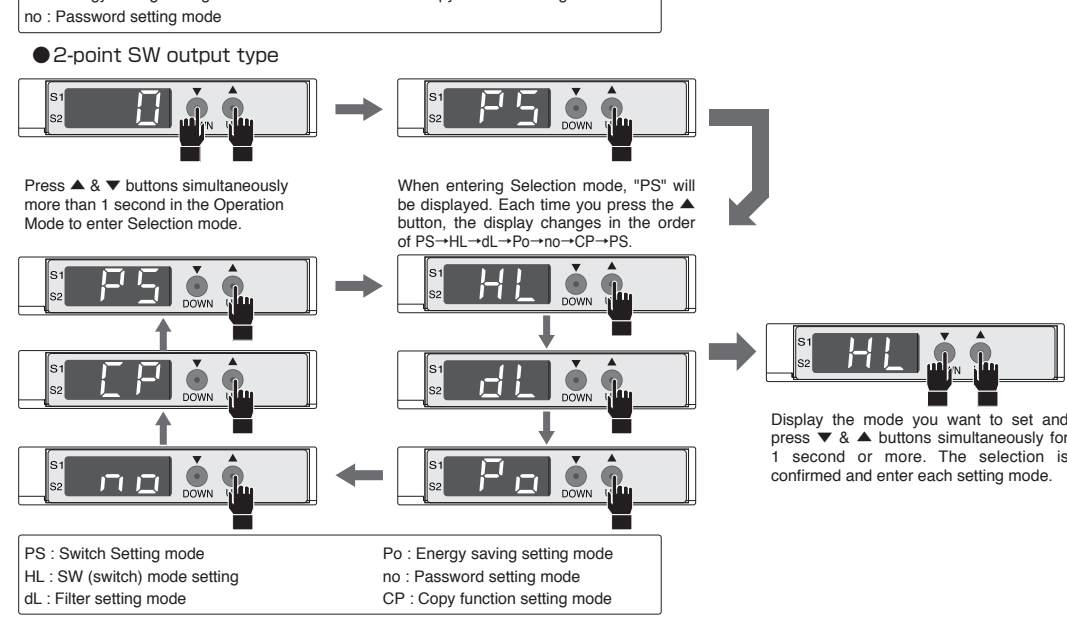
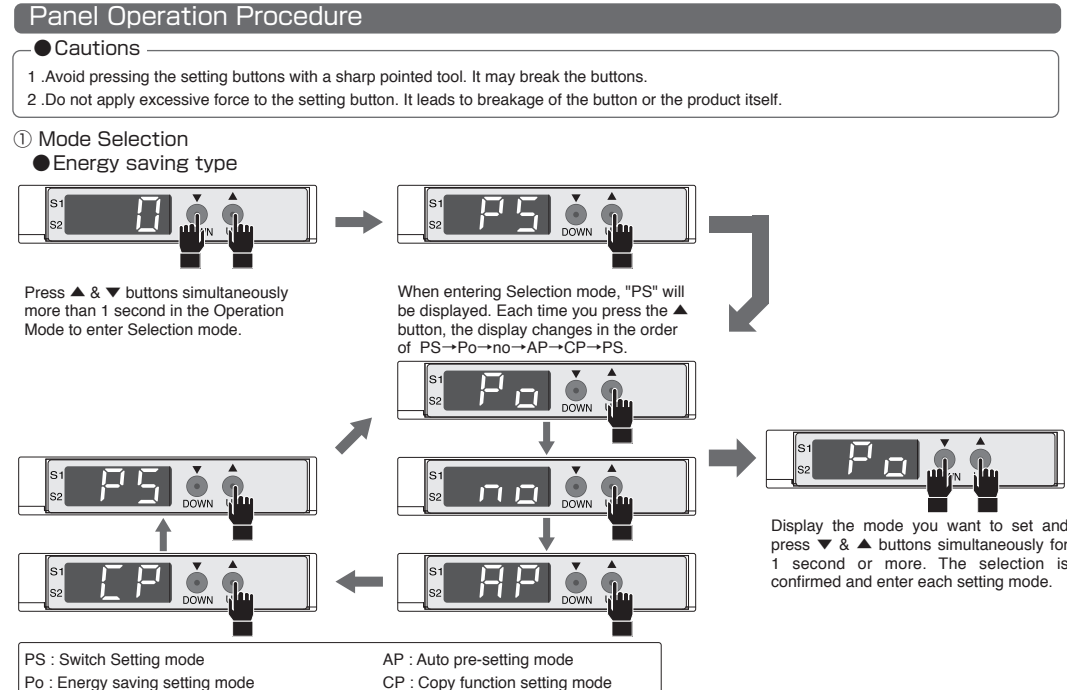
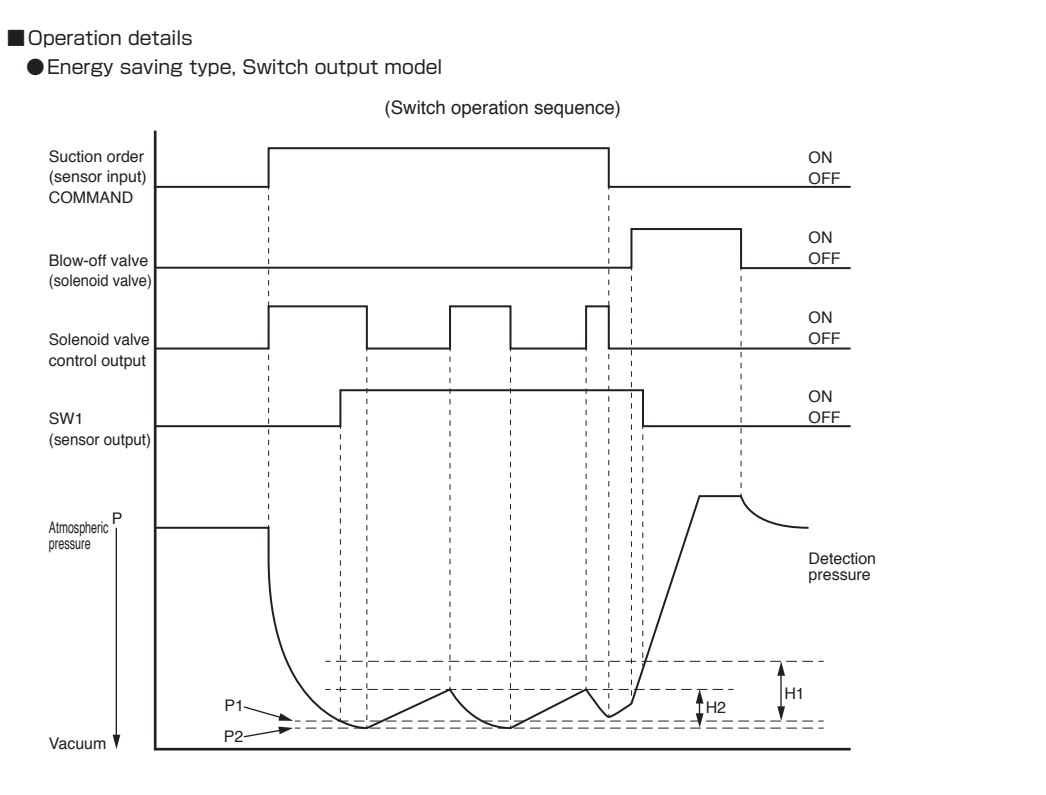
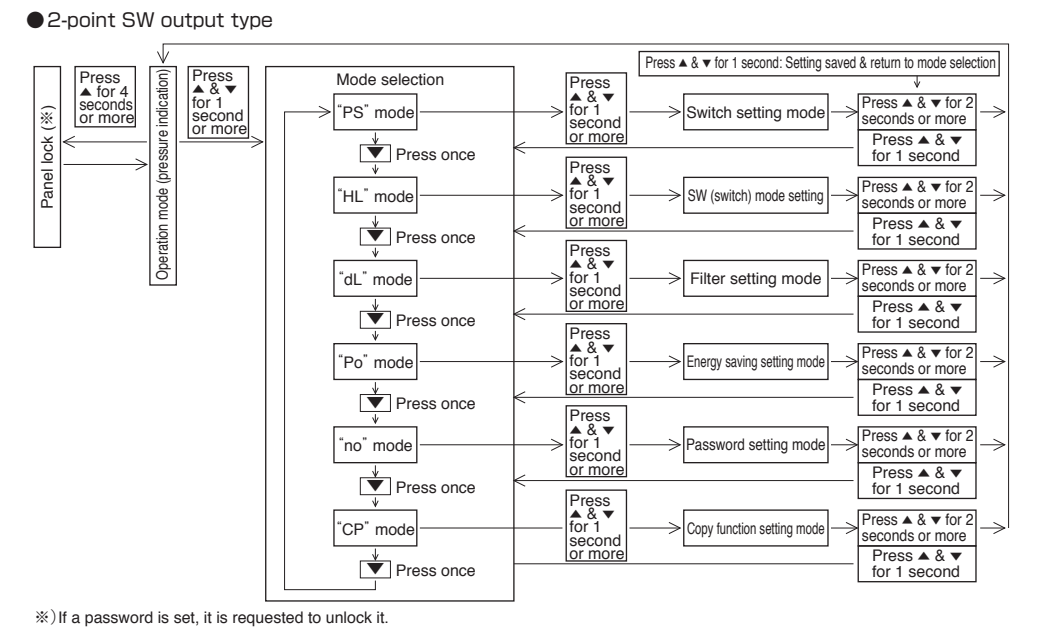
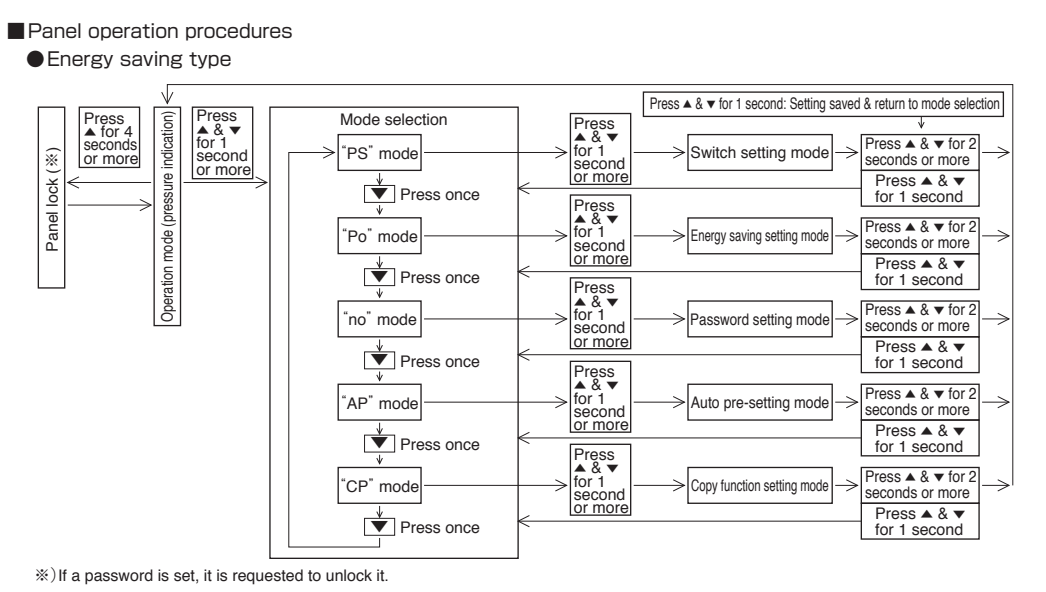
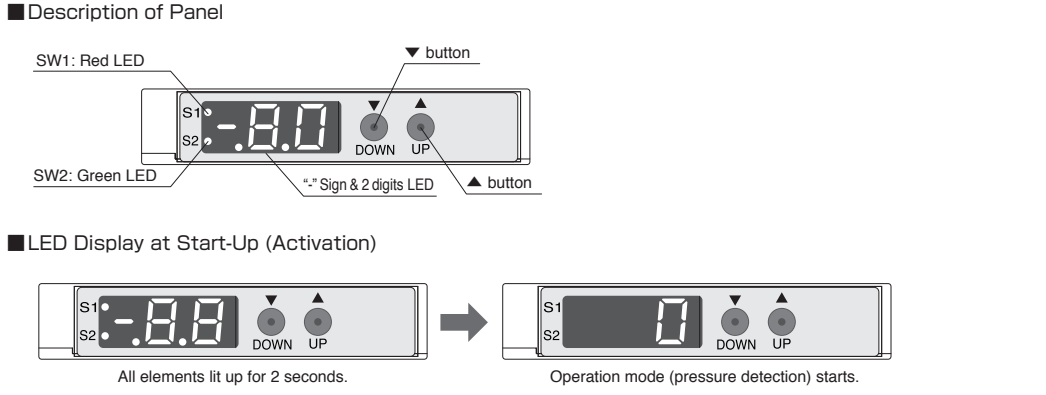
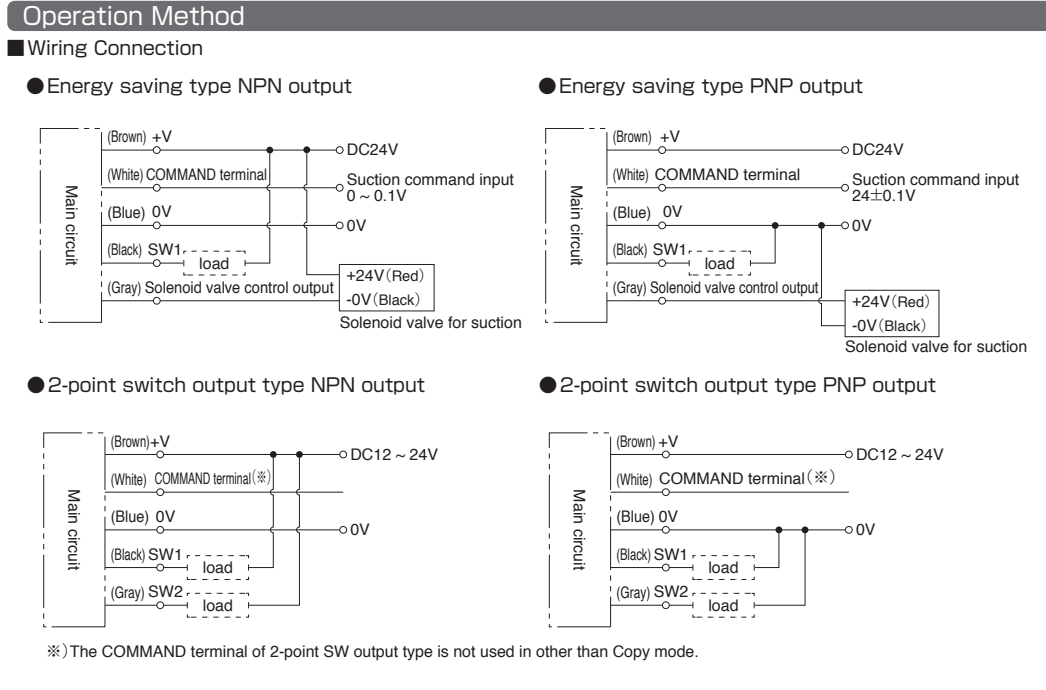

Error Indication

Error No.	Error details	How to deal with error
E1	The load current of the switch exceeds the allowable value.	Turn off the power, find the cause, lower the load current to the allowable value, then turn on the power again.
E2	Pressure such as residual pressure is applied at the time of "0" point adjustment.	Cancel E2 by pressing ▲ button and return to Operation Mode. Release a pressure in the pressure port, and conduct zero point adjustment again.
E3	A PISCO representative will need to see the sensor unit.	Please consult the nearest PISCO office.

